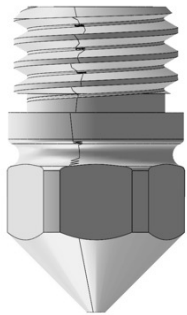

TABLE OF CONTENTS

- Nozzles** 1
 - Wanhao Nozzles*** 1
 - UM2 Nozzles*** 2
 - Everlast*** 10

NOZZLES

WANHAO NOZZLES



WANHAO 0.40 - 0.80MM MATCHLESS

Wanhao Matchless (1.75mm fil). Multiply printing speed. Requires All Metal hotend upgrade. A fantastic nozzle!

This high tech nozzle ONLY works for Wanhao with the All Metal Hotend upgrade.

The 0.80mm will finish a print 4-10 times faster than a standard 0.40mm nozzle, provided you can live with the added layer width (0.8mm instead of 0.4mm), and a higher layer. Very popular for printing large objects or small low res models.

It is made of brass with a multilayer hard metal coating.

Weight	3 kg
Dimensions	8 x 6 x 1 cm
Nozzle Size (mm)	0.40, 0.80

[Read More](#)

Variations

SKU	Description	Nozzle Size (mm)	Price
7072482001311		0.80	€ 16,00
7072482001304		0.40	€ 16,00

SKU: N/A

Price: € 16,00

Category: [Wanhao Nozzles](#)

UM2 NOZZLES



UM2+ 5- ICE NOZZLE KIT W/ 0.40 EVERLAST RUBY

This great kit consists of 5 nozzles, for the UM2+ / Matchless / Olsson / E3D:
0.25-0.40-0.60-0.80 ICE Brass nozzles + 0.40 Everlast Ruby

This great kit consists of 5 nozzles, for the UM2+ / Matchless / Olsson Block / E3D:
0.25-0.40-0.60-0.80 ICE Brass nozzles + 0.40 Everlast Ruby
All the nozzles are brass nozzles. Except for the EVERLAST Ruby 0.40, they are coated with a hard and slippery material which makes cleaning a lot easier, and helps preventing plastic stick and being carried around the print.
These nozzles are standard nozzles except the Everlast which has the "Matchless" design of heating the filament.

This enables higher printing speeds and / or lower temperature, which again helps against dripping.

The ICE nozzles look a bit irregular on the surface due to the treatment, but this quickly evens out and does not affect printing. The nozzles have a run-in period of 2 hours at 200C-225C, to harden, tempering the surface.

After that they should be used at max 265C. Higher temperatures than 265C will destroy the treatment and the nozzle is the just like any other nozzle!

ONLY the Everlast is recommended for abrasive materials, the other nozzles will wear out quickly.

Weight 0.05 kg
Dimensions 5 x 5 x 2 cm

[Read More](#)

SKU: 7072482001946

Price: € 143,00 € 99,00

Categories: [UM2 Nozzles](#), [Nozzles](#), [UM2 Nozzles](#)



0.80 mm
Matchless RACE

UM2 0.80 MM MATCHLESS

Optimized for 3D Solex V3 Block. Backwards compatible with "Olsson Block". This high temperature nozzle provides high output. Alternatively, you can print cooler!

Prints up to 4 times faster.

Prints cooler, - 5-15 deg Celcius.

100% drop-in backwards compatible with "Olsson Block".

-Matchless Race Technology prints up to 4 times faster than a standard nozzle of the same size.

-Chrome coated Brass. Makes for easier outside cleaning.

-Precision manufacture at an ISO 9001 certified facility.

Weight 3 kg
Dimensions 8 x 6 x 1 cm
Filament Size 1.75mm, 2.85mm

[Read More](#)

Variations

SKU	Description
7072482000802	Native Nozzle for 2.85mm filament. Precision engineered.
7072482000901	Native nozzle for 1.75mm filament. Precision Engineered.

SKU: N/A

Price: € 14,00

Categories: [UM2 Nozzles](#), [UM2 Nozzles](#)

ULTIMAKER Upgrades-3D Printer Nozzles



0.60 mm
Matchless RACE

UM2 0.60MM MATCHLESS

Optimized for 3D Solex V3 Block. Backwards compatible with "Olsson Block". This high tech nozzle will significantly increase plastic output, completing prints faster. Alternatively, you can print cooler!

Prints up to 4 times faster than a standard 0,40mm nozzle.
Prints cooler, - 5-15 deg Celcius.
100% drop-in backwards compatible with "Olsson Block".
-Matchless Race Technology prints up to 4 times faster then a standard nozzle of the same size.
-Chrome coated Brass. Makes for easier outside cleaning.
-Precision manufacture at an ISO 9001 certified facility.

Weight 2 kg
Dimensions 8 x 6 x 1 cm
Filament Size 1.75mm, 2.85mm

[Read More](#)

Variations

SKU	Description	Filament Size	Price
2.85mm: 7072482000796	Native Nozzle for 2.85mm filament. Precision engineering.	2.85mm	€ 14,00
1.75mm: 7072482000895	Native Nozzle for 1.75mm filament. Precision engineering.	1.75mm	€ 14,00

SKU: N/A

Price: € 14,00

Categories: [UM2 Nozzles](#), [UM2 Nozzles](#)



0.40 mm
Matchless RACE

UM2 0.40MM MATCHLESS

Optimized for 3D Solex V3 Block. Backwards compatible with "Olsson Block". This high tech nozzle will significantly increase plastic output, completing prints faster. Alternatively, you can print cooler!

Prints up to 3 times faster than a standard 0,40mm nozzle.
Prints cooler, - 5-15 deg Celcius.
100% drop-in backwards compatible with "Olsson Block".
-Matchless Race Technology prints up to 3 times faster then a standard nozzle of the same size.
-Chrome coated Brass. Makes for easier outside cleaning.
-Precision manufacture at an ISO 9001 certified facility.

Weight 0.005 kg
Dimensions 8 x 6 x 1 cm
Filament Size 1.75mm, 2.85mm

[Read More](#)

Variations

SKU	Description	Filament Size	Price
7072482000772	Native Nozzle for 2.85mm filament. Precision engineering.	2.85mm	€ 14,00
7072482000871	Native Nozzle for 1.75mm filament. Precision engineering.	1.75mm	€ 14,00

SKU: N/A

Price: € 14,00

Categories: [UM2 Nozzles](#), [UM2 Nozzles](#)

ULTIMAKER Upgrades-3D Printer Nozzles



0.25 mm
Matchless

UM2 0.25MM MATCHLESS

Optimized for 3D Solex V3 Block. Backwards compatible with "Olsson Block".

For fine, detailed work.

100% drop-in backwards compatible with "Olsson Block".

-Matchless Race Technology prints up to 3 times faster then a standard nozzle of the same size.

(not for 0.25 mm nozzle, the slow printing speed does not benefit from RACE).

-Chrome coated Brass. Makes for easier outside cleaning.

-Precision manufacture at an ISO 9001 certified facility.

Weight	2 kg
Dimensions	8 x 6 x 1 cm
Filament Size	1.75mm, 2.85mm

[Read More](#)

Variations

SKU	Description	Filament Size	Price
7072482000765	Native Nozzle for 2.85mm filament. Precision engineering.	2.85mm	€ 14,00
7072482000864	Native Nozzle for 1.75mm filament. Precision engineering.	1.75mm	€ 14,00

SKU: N/A

Price: € 14,00

Categories: [UM2 Nozzles](#), [UM2 Nozzles](#)



2.0 mm
Matchless RACE

UM2 2.0MM MATCHLESS

Optimized for 3D Solex V3 Block. Backwards compatible with "Olsson Block". This high tech nozzle will significantly increase plastic output, completing prints faster. Alternatively, you can print cooler!

Prints a 2.0 mm wide layer!

Prints cooler, - 5-15 deg Celcius.

100% drop-in backwards compatible with "Olsson Block".

-Matchless Race Technology prints up to 4 times faster then a standard nozzle of the same size.

-Chrome coated Brass. Makes for easier outside cleaning.

-Precision manufacture at an ISO 9001 certified facility.

Weight	2 kg
Dimensions	8 x 6 x 1 cm
Filament Size	1.75mm, 2.85mm

[Read More](#)

Variations

SKU	Description	Filament Size	Price
7072482000833	Native Nozzle for 2.85mm filament. Precision engineering.	2.85mm	€ 14,00
7072482000932	Native Nozzle for 1.75mm filament. Precision engineering.	1.75mm	€ 14,00

SKU: N/A

Price: € 14,00

Categories: [UM2 Nozzles](#), [UM2 Nozzles](#)

ULTIMAKER Upgrades-3D Printer Nozzles

**UM2 1.5MM MATCHLESS**

Optimized for 3D Solex V3 Block. Backwards compatible with "Olsson Block". This high tech nozzle will significantly increase plastic output, completing prints faster. Alternatively, you can print cooler!

- Prints a 1.5mm wide layer!
- Prints cooler, - 5-15 deg Celcius.
- 100% drop-in backwards compatible with "Olsson Block".
- Matchless Race Technology prints up to 4 times faster than a standard nozzle of the same size.
- Chrome coated Brass. Makes for easier outside cleaning.
- Precision manufacture at an ISO 9001 certified facility.

Weight 2 kg
Dimensions 8 x 6 x 1 cm
Filament Size 1.75mm, 2.85mm

[Read More](#)

Variations

SKU	Description	Filament Size	Price
7072482000826	Native Nozzle for 2.85mm filament. Precision engineering.	2.85mm	€ 14,00
7072482000925	Native Nozzle for 1.75mm filament. Precision engineering.	1.75mm	€ 14,00

SKU: N/A
Price: € 14,00
Categories: [UM2 Nozzles](#), [UM2 Nozzles](#)

**UM2 1.0MM MATCHLESS**

Optimized for 3D Solex V3 Block. Backwards compatible with "Olsson Block". This high tech nozzle will significantly increase plastic output. Alternatively, you can print cooler!

- Prints up to 4 times faster.
- Prints cooler, - 5-15 deg Celcius.
- 100% drop-in backwards compatible with "Olsson Block".
- Matchless Race Technology prints up to 4 times faster than a standard nozzle of the same size.
- Chrome coated Brass. Makes for easier outside cleaning.
- Precision manufacture at an ISO 9001 certified facility.

Weight 3 kg
Dimensions 8 x 6 x 1 cm
Filament Size 1.75mm, 2.85mm

[Read More](#)

Variations

SKU	Description
7072482000819	Native Nozzle for 2.85mm filament. Precision engineering.
7072482000918	Native nozzle for 1.75mm filament. Precision Engineering.

SKU: N/A
Price: € 10,00 - € 14,00
Categories: [UM2 Nozzles](#), [UM2 Nozzles](#)

ULTIMAKER Upgrades-3D Printer Nozzles

**SS 50 "ICE" - 0.50MM NOZZLE**

Helps preventing PLA from sticking to your nozzle Will not carry blobs of PLA or any other filament around your print! Super easy [Cold Pull!](#)
0.50mm size can have an advantage with certain difficult, fibrous filaments, less clogging. Lasts even longer than stainless steel nozzles. For some users it will "payback" after first use!
(Ill. image- actual image coming).
For UM2/ UM2+

This fantastic newly developed product by 3D Solex has a core of stainless steel and a multi-component molecularly interlocked tempered surface with 2 main advantages:

- 1) **PLA (or any other filament we know of) simply refuses to stick to it.**
- 2) **Cold Pulls work so much better, the inside of the nozzle is "ICE" too.**
- 3) **Its surface is much more wear resistant than that of stainless steel, so it will last much longer**

printing abrasive filaments. Compared with brass, - it is in a class of its own.

It also works exceptionally well with chemically challenging chemicals, like glow, flexible materials, + many more.

These are the three fantastic advantages of this nozzle.

Now blobs of filament will not be carried around and depositet on your print.

It still prints slower than a brass nozzle.

Downside: A stainless steel based nozzle will not allow you to print as fast as a brass one. Use: Run-in period of 2 hours at max 220C. This hardens/temperes it, after that, Max temp 280C.

For UM2 w/Olsson Block UM2+, Matchless V3.

Much stronger than steel nozzle. Not as fast as a brass nozzle.

[Read More](#)

SKU: 7072482000161

Price: € 16,00 € 12,50

Categories: [UM2 Nozzles](#), [UM2 Nozzles](#)

**SS 40 "ICE" - 0.40MM NOZZLE**

Helps prevent PLA sticking to nozzle Will not carry blobs of PLA or any other filament around your print!

Super easy [Cold Pull!](#)

Lasts even longer than stainless steel nozzles. For some users it will "payback" after first use!

(Ill. image- actual image coming).

For UM2/ UM2+

This fantastic newly developed product by 3D Solex has a core of stainless steel and a multi-component molecularly interlocked tempered surface with 2 main advantages:

- 1) **PLA (or any other filament we know of) simply refuses to stick to it.**

2) **Cold Pulls work so much better, the inside of the nozzle is "ICE" too.**

- 3) **Its surface is much more wear resistant than that of stainless steel, so it will last much longer printing abrasive filaments. Compared with brass, - it is in a class of its own.**

It also works exceptionally well with chemically challenging chemicals, like glow, flexible materials, + many more.

These are the three fantastic advantages of this nozzle.

Now blobs of filament will not be carried around and depositet on your print.

It still prints slower than a brass nozzle.

Downside: A stainless steel based nozzle will not allow you to print as fast as a brass one.

Use: Run-in period of 2 hours at max 220C. This hardens/temperes it, after that, Max temp 280C.

For UM2 w/Olsson Block UM2+, Matchless V3.

Much stronger than steel nozzle. Not as fast as a brass nozzle.

[Read More](#)

SKU: 7072482000154

Price: € 16,00 € 12,50

Categories: [UM2 Nozzles](#), [UM2 Nozzles](#)

ULTIMAKER Upgrades-3D Printer Nozzles



S5 - UM3 Hardcore EVERLAST RUBY SAPPHIRE NOZZLE

Super hard and super fast nozzles for Ultimaker Hardcore. You can now print almost any abrasive material. Almost forever!



-some of the Everlasts..

These nozzles will allow you to print spool after spool of Carbon Fibre, Bronzefill and other abrasive materials. They also leave a particularly beautiful print with PLA, ABS and other filaments. **We now also have 0.50mm EVERLAST! This is perfect for architects and engineers, for a sometimes better "relation" to the slicer in a metric model. Example when walls are 0.50 mm this nozzle for Google and are now adding it to our catalog, for you.**

Printing Carbon Fibre on a standard Core will destroy it completely in a few hours, or less than 500g filament.

This nozzle can print all day long, week after week.

Many users experience that the EVERLAST Ruby "paid itself back" after 1 time use only!

Weight
Dimensions
Choose Size (mm)

[Read More](#)

Variations

SKU	Description	Select Size (mm)	Price
707248200123		0.25	€ 8,00
707248200147		0.40	€ 8,00
7072482001649		0.60	€ 8,00
7072482001656			
7072482001663		0.80	€ 8,00
7072482001670			
7072482001687			
7072482001694			
7072482001700	This great kit consists of ALL 6 Everlast Nozzles sized 0.25,0.40,. 0.50,0.60,0.80-1.2mm for the UM3 Hardcore. 1 of the nozzles is "free" in the kit		

SKU: N/A
Price: € 64,00 - € 320,00
Categories: [Ultimaker S5](#), [Ultimaker 3](#), [Ultimaker 3 Nozzles](#), [UM2 Nozzles](#)



RSB JET NOZZLE 0.25-0.80MM

Standard Nozzle. High quality. Made in Norway. If your print crashes, you cannot blame it on this nozzle, it is likely something else.

Fits UM2-UM3, E3D, Olsson Block, Matchless V3

Weight 0.003 kg

Select Size (mm) 0.10, 0.15, 0.25, 0.40, 0.60, 0.80, 1.0

[Read More](#)

Variations

SKU	Description	Select Size (mm)	Price
707248200123		0.25	€ 8,00
707248200147		0.40	€ 8,00
7072482001649		0.60	€ 8,00
7072482001663		0.80	€ 8,00

SKU: N/A
Price: € 8,00
Categories: [UM2 Nozzles](#), [UM2 Nozzles](#)

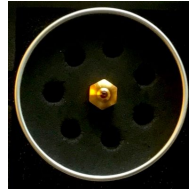

EVERLAST UM2+ NOZZLES 0.25-0.80 MM

Super hard and super fast nozzles for UM2+.

These nozzle will allow you to print spool after spool of Carbon Fibre, Bronzefill and other abrasive materials. They also leave a particularly beautiful print with PLA , ABS and other filaments. Printing Carbon Fibre on a standard nozzle will destroy it completley in a few hours, or less than 500g filament, but what is more, you will not be able to finish even one print if it is big enough! This nozzle can print all day long, week after week. Print at 5-15 degrees higher temperature (PLA). Many users experience that the EVERLAST "paid back" after 1 time use only!

Weight 0.02 kg
Choose Size (mm) 0.25, 0.40, 0.50, 0.60, 0.80, 1.20

[Read More](#)

Variations

SKU	Description	Choose Size (mm)	Price
7072482001137	0.40mm Everlast Matchless. "normal" size.	0.40	€ 74,00
7072482001120	0.25mm Everlast nozzle. For tiny, detailed work.	0.25	€ 69,00
7072482001144	0.60mm Everlast Matchless. Oversize.. will help you if fibres tend to get "stuck" in nozzle. Use with line width setting 0.40-0.65.	0.60	€ 74,00
7072482001151	0.80mm Everlast Matchless. The area of the exit of this nozzle is about 4 times bigger than that of 0.40 nozzle. You can finish a print many times faster compared to using a standard 0.40mm core.	0.80	€ 74,00

SKU: N/A
Price: € 69,00 - € 74,00
Categories: [Ultimaker 2](#), [UM2 Nozzles](#), [Everlast](#), [UM2 Nozzles](#)



RSB "ICE" SURFACE NOZZLE 0.25-1.00

NEW Nozzle from 3D Solex!
 Slippery "ICE" nozzle, with brass core. Optimized for surface prints. Max temp 275C. First 2 hours max 220C to temper the nozzle. Super Easy Cold-Pulls!

Has an outer geometry optimized for surfaces. This is a brass nozzle (excellent temperature properties) with a hard coating of a slippery "ICE" coating. This coating prevents hot plastic sticking to it! A super nozzle!
 If you heat it to more than 275C, it destroys this function and the nozzle acts like a "normal" nozzle.
 IMPORTANT: This ICE nozzle looke like a (dark) steel nozzle, but it is a brass nozzle! This means it prints just like a standard brass nozzles (several times faster than steel nozzles). Fits UM2- UM2+, Olsson Block, Matchless V3

Weight N/A
Select Size (mm) 0.25, 0.40, 0.60, 0.80, 1.00

[Read More](#)

Variations

SKU	Description	Select Size (mm)	Price
7072482000178		0.40	€ 12,00
7072482000130		0.25	€ 12,00
7072482000208	Prints much more plastic than 0.40 nozzle, allmost twice opening area of nozzle. Super slippery surface.	0.60	€ 12,00
7072482000246	Super slippery Surface! Super easy Cold pull!	0.80	€ 12,00
7072482000277	Prints slowly, as it has not the Matchless Race technology. Super sllippery surface!	1.00	€ 12,00

SKU: N/A
Price: € 12,00
Categories: [UM2 Nozzles](#), [UM2 Nozzles](#)

ULTIMAKER Upgrades-3D Printer Nozzles

**0.15MM MICRO NOZZLE**

This is the World's 2.nd smallest Nozzle. They are individually drilled and checked, and very difficult to use.

For Experts Only. Needs geared feeder. (Bondtech, Iroboti/Meduza, UM2+).
YOU will NOT be able to use this item with an original UM2.

This is the World's 2.nd smallest 3d printer nozzle. They are individually drilled and checked, and extremely difficult to manufacture.

These are difficult to use, and we recommend that you can print with an 0.25 nozzle "blindfoldedly" before using this one. Prints at lower temp (190 - 205C), since the material stays long time inside. Do not change material type without "Cold Pulls" in between. Use Cold Pull before and after every print. This cleans out the nozzle.

What is this nozzle used for?

- Kanji, Japanese art writing
- Custom PCB manufacture
- Miniature drone parts
- Miniature tools and gadgets
- Other use

World's smallest drill is made with our 0.25mm nozzle. The 0.15mm has the surface area (opening size) of only about 30% of a 0.25mm hole.

A 0.40mm nozzle has a 15 times higher plastic output than the 0.10mm 3D Solex Micro. This nozzle will not work with an ungeared feeder like UM2 (not "+"), or without a high tech feeder like Bondtech. Made in Norway by hand, using a Swiss "drill" and German tools.
<https://www.youtube.com/watch?v=gTb9FtcpVol>

Weight 2 kg
Dimensions 8 x 6 x 1 cm

[Read More](#)

SKU: 7072482000109

Price: € 39,00

Categories: [UM2 Nozzles](#), [UM2 Nozzles](#)

**0.10MM SUB MICRO**

This is the World's smallest Nozzle. They are individually drilled and checked, and very difficult to use.

For Experts Only. Needs geared feeder. (Bondtech, Iroboti/Meduza, UM2+).

YOU will NOT be able to use this item with an original UM2.

This is the World's smallest 3d printer nozzle. They are individually drilled and checked, and extremely difficult to manufacture.

These are difficult to use, and we recommend that you can print with an 0.15 nozzle "blindfoldedly" before using this one. Prints at lower temp (190 - 205C), since the material stays long time inside. Do not change material type without "Cold Pulls" in between. Use Cold Pull before and after every print. This cleans out the nozzle.

What is this nozzle used for?

- Kanji, Japanese art writing
- Custom PCB manufacture
- Miniature drone parts
- Miniature tools and gadgets
- Other use

World's smallest drill is made with our 0.25mm nozzle. The 0.10. has the surface area (opening size) of only about 14% of a 0.25mm hole.

A 0.40mm nozzle has a 15 times higher plastic output than the 0.10mm 3D Solex Micro. This nozzle will not work with an ungeared feeder like UM2 (not "+"), or without a high tech feeder like Bondtech. Made in Norway by hand, using a Swiss "drill" and German tools.
<https://www.youtube.com/watch?v=gTb9FtcpVol>

Weight 2 kg
Dimensions 8 x 6 x 1 cm

[Read More](#)

SKU: 7072482000086

Price: € 49,00

Categories: [UM2 Nozzles](#), [UM2 Nozzles](#)

EVERLAST



UM2+ EVERLAST DIAMOND NOZZLE

DIAMOND tipped nozzle. We are supplying this nozzle to a German university. Diamond has exceptional thermal properties, far outshining any other known mineral or metal.

World's fastest and biggest
3D Solex WORLD CLASS

MATCHLESS

These nozzles will allow you to print spool after spool of ANY material. Our clients appreciate the following two features:

- 1) The tip will never wear out from printing
- 2) The tip is always "hot", so releases filaments better than any other nozzle.

There is a 1 year guarantee on this nozzle.

- 1) If it clogs up, we fix it.
- 2) If the tip wears out, you get a new nozzle.

This nozzle is built with our patented MATCHLESS technology. These parts inside the nozzle will wear out.

The guarantee cannot cover this worn out mechanism. In the event that you should irrecoverably clog this nozzle, we will restore the nozzle and remove the Matchless core. The nozzle will then behave like any ordinary nozzle; speed-wise. The diamond tip will still be hot.

We soon also have 0.50mm DIAMOND! This is perfect for architects and engineers, for a sometimes better "relation" to the slicer in a metric model. Example when walls are 0.50 mm, 1.0mm, and so on. We are making this nozzle for Google and are now adding it to our catalog, for you.

Printing Carbon Fibre on a standard nozzle will destroy it completely in a few hours, or less than 500g filament.

This nozzle can print all day long, month after month.

Weight N/A
Dimensions N/A
Choose Size (mm) 0.50, 0.60, 0.80

[Read More](#)

Variations

SKU	Description	Choose Size (mm)	Price
7072482001182		0.50	€ 330,00
7072482001212		0.60	€ 330,00
7072482001731-1		0.80	€ 330,00

SKU: N/A

Price: € 330,00

Categories: [UM2 Nozzles](#), [Everlast](#)

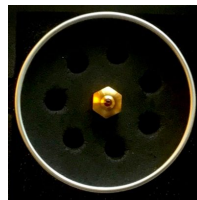

EVERLAST UM2+ NOZZLES 0.25-0.80 MM

Super hard and super fast nozzles for UM2+.

These nozzle will allow you to print spool after spool of Carbon Fibre, Bronzefill and other abrasive material. Printing Carbon Fibre on a standard nozzle will destroy it completely in a few hours, or less than 500g filament.

This nozzle can print all day long, week after week.

Print at 5-15 degrees higher temperature (PLA).

Many users experience that the EVERLAST "paid back" after 1 time use only!

Weight
Choose Size (mm)

[Read More](#)

Variations

SKU	Description
7072482001137	0.40mm Everlast Matchless. "normal" size.
7072482001120	0.25mm Everlast nozzle. For tiny, detailed work.
7072482001144	0.60mm Everlast Matchless. Oversize.. will help you if fibres tend to clog.
7072482001151	0.80mm Everlast Matchless. The area of the exit of this nozzle is about 2x larger than a standard nozzle.

SKU: N/A

Price: € 69,00 - € 74,00

Categories: [Ultimaker 2](#), [UM2 Nozzles](#), [Everlast](#), [UM2 Nozzles](#)

ULTIMAKER Upgrades-3D Printer Nozzles

**EVERLAST RUBY RAISE3D NOZZLES**

**Super hard and super fast nozzles for Raise3D.
You can now print almost any abrasive material on your Raise3D,
Almost forever!**

These nozzles will allow you to print spool after spool of Carbon Fibre, Bronzefill and other abrasive materials. They also leave a particularly beautiful print with PLA , ABS and other filaments. Printing Carbon Fibre on a standard Core will destroy it completely in a few hours, or less than 500g filament. This nozzle can print all day long, week after week. Many users experience that the EVERLAST Ruby "paid itself back" after 1 time use only!

Weight 0.02 kg
Dimensions 5 x 5 x 3 cm
Choose Size (mm) 0.25mm, 0.40mm, 0.50mm, 0.60mm, 0.80mm, 1.20mm, 25-40-60-80-1.20mm

[Read More](#)

Variations

SKU	Description	Choose Size (mm)	Price
7072482001908	0.40mm "normal" size.	0.40mm	€ 59,00
7072482001915	0.60mm oversize.. will help you if fibres tend to get "stuck" in nozzle. Use with line width setting 0.40-0.65.	0.60mm	€ 59,00
7072482001922	0.80mm Everlast Matchless nozzle. The area of the exit of this nozzle is about 4 times that of 0.40 nozzle. You can finish a big print many times faster.	0.80mm	€ 59,00

SKU: N/A

Price: € 59,00

Categories: [Raise3D Matchless Nozzles](#), [Everlast](#)